

MT9085 Series ACCESS Master Firmware Update Procedure (USB Cable Connection)

3rd Edition

Firmware Update Procedure (USB Cable Connection)

The Firmware Update Procedure (USB Cable Connection) is used to add new functions to the MT9085 Series ACCESS Master and resolve any known problems. The firmware is updated by installing the file released by Anritsu.

This document explains how to upgrade the firmware using a USB Cable.

Notes:

- BEFORE performing this firmware upgrade, ALWAYS read the MT9085 Series ACCESS Master Firmware Update Procedure (this document) and the Operation Manual for MT9085 Series ACCESS Master.
- Perform the upgrade with the AC adapter connected to the MT9085 Series ACCESS Master.

Step 1: Expanding file downloaded from Internet

The firmware update file can be downloaded to a PC from the Firmware Download site at Anritsu's Web page.

Download file name:

MX9085x_vxxx_E.zip (xxx: Version; example: MX9085x_v100_E.zip)

The download file is provided as a .zip file. Copy the downloaded file to a folder on the PC and then expand it. The following files will be extracted.

- 1) MT9085_Install_vxxx.apm (MT9085 firmware update file version xxx)
- 2) MT9085_DownloadManual_E.pdf (Download manual: this document)
- 3) MT9085_ReleaseNote_vxxx_E.pdf (Release notes)
- 4) Readme_eng.txt (version information for expanded file)

Notes:

- Always read the Release notes and confirm the firmware version of the MT9085 Series ACCESS Master before running the update. If the firmware version is the same as the firmware update version, there is no need to update the firmware.

Step 2: Copying firmware update file (MT9085_Install_vxxx.apm) to Internal Memory of MT9085

Using the following procedure copy the firmware update file (MT9085_Install_vxxx.apm) download by procedure 1 from the customer's PC to the internal memory of MT9085 Series ACCESS Master.

Use a USB cable to connect the customer's PC and the USB Up Port of MT9085 Series ACCESS Master (Fig. 1). At the PC, select and open the removable disk. Access the internal memory of MT9085 Series ACCESS Master from the PC and drag the update file from the PC to MT9085 Series ACCESS Master (Fig. 2) to copy it to the internal memory.

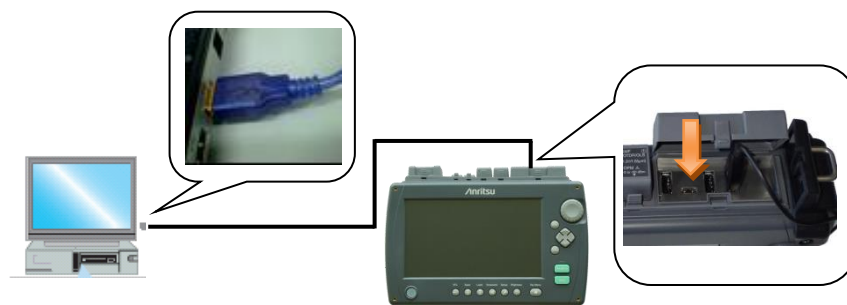

Fig. 1 USB Cable Connection

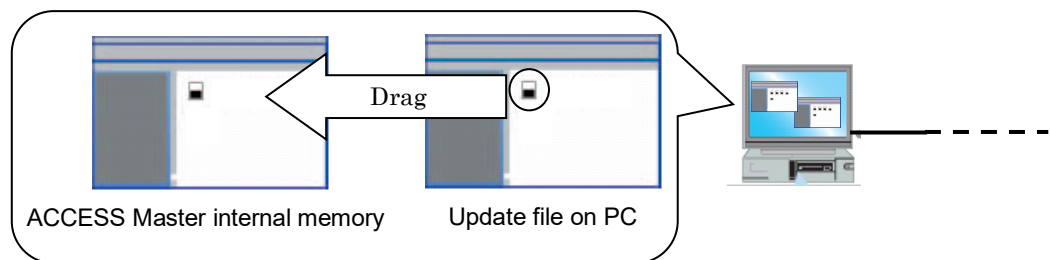

Fig. 2 Copying Update File to ACCESS Master

After copying the file to internal memory using the above procedure, safely disconnect the USB cable connection between the MT9085 Series ACCESS Master and the PC by referring to the PC operation manual.

Step 3: Displaying firmware update screen

Press the Top menu key to display the Top menu (Fig. 3) and then press the Setup key to display the General Configuration screen.



Fig. 3 Top Menu

After the General Configuration screen (Fig. 4) is displayed, Touch the About key to display the About screen.

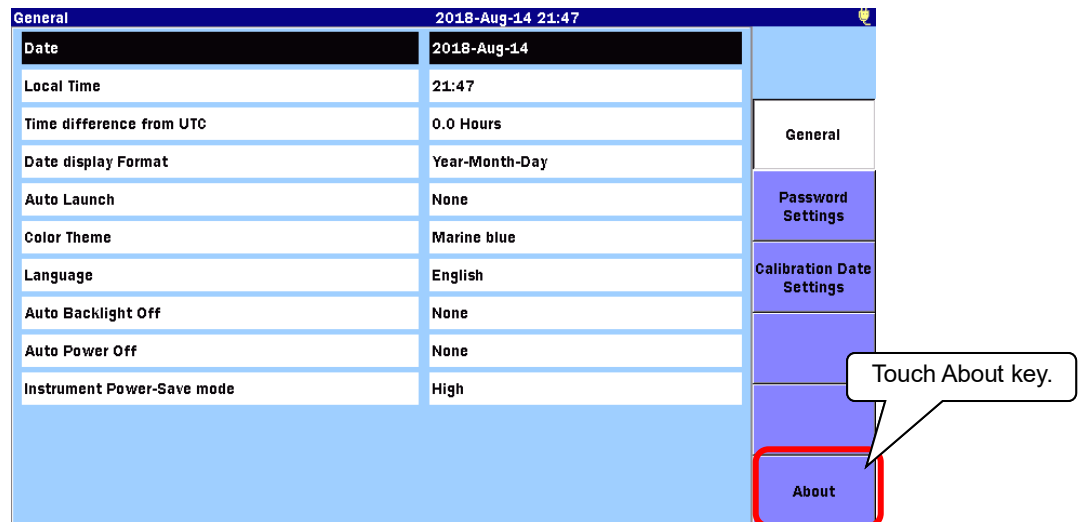

Fig. 4 General Screen

When the About screen (Fig. 5) is displayed, touch the Update Firmware to display the Update Firmware (Fig. 4).

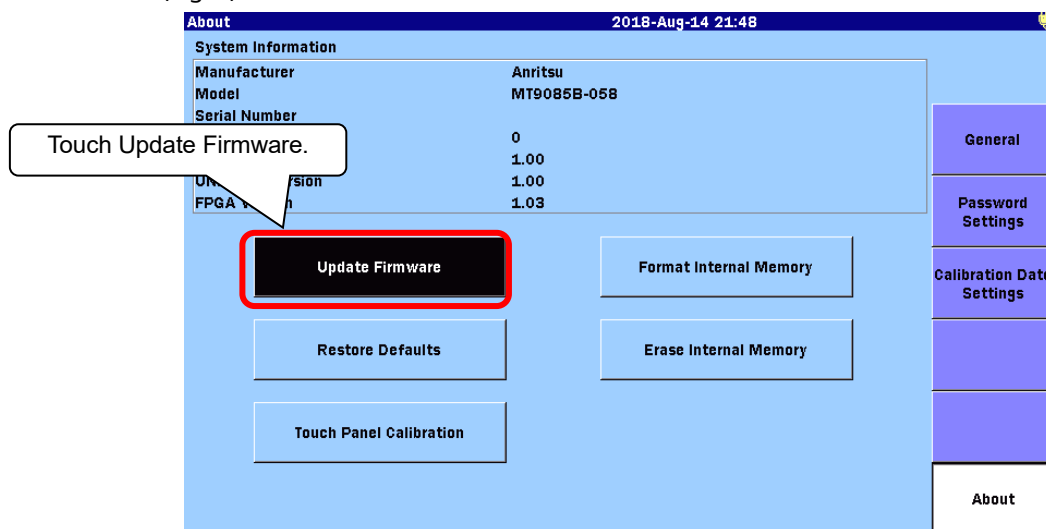

Fig. 5 About Screen

Step 4: Reading firmware update file

The default folder at the Load screen is Internal Memory. If this folder is USB Memory, touch Medium to change to Internal Memory containing the update file.

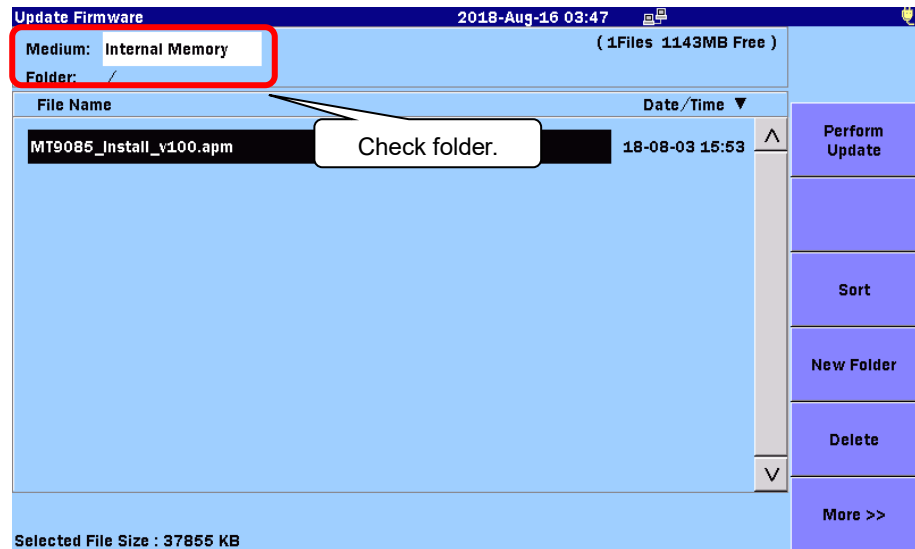

Fig. 6 Update Firmware Screen

At the Load Screen (Fig. 6), check that the folder has changed to [Internal Memory]. If the firmware update file (MT9085_Install_vxxx.apm) is in a different folder, select that correct folder. Then select the firmware update file and touch Perform Update key to read the file.

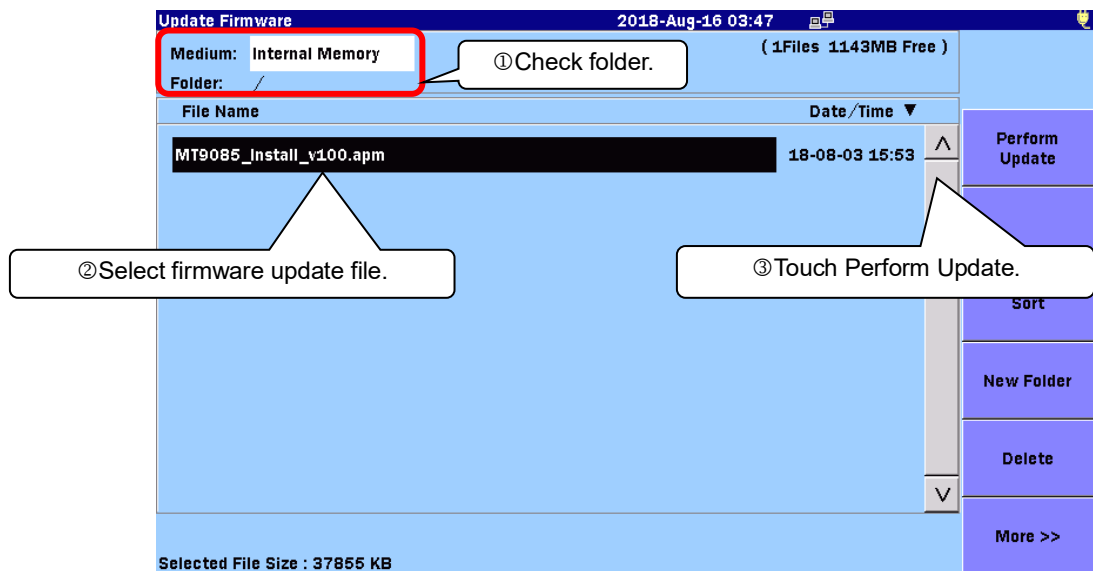

Fig. 7 Update Firmware Screen

Step 5: Updating firmware

When Step 4 is executed, the Firmware Update Confirmation message (Fig. 8) is displayed. This screen displays the versions of the current firmware and the new update firmware.

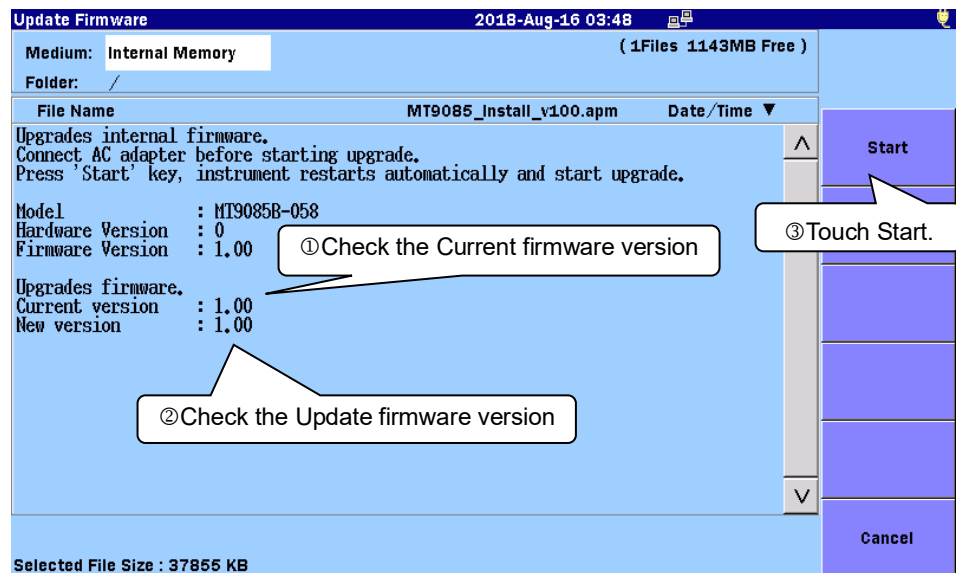

Fig. 8 Firmware Update Confirmation Screen

To start the firmware update, touch Start; to cancel it, touch Cancel.

When the checks of firmware update file successfully, the MT9085 Series ACCESS Master restarts automatically.

Then, firmware will be updated.

The MT9085 Series ACCESS Master will be restarted when complete the firmware update.

If the firmware update stalls midway, perform the following:

1. If the firmware update file is damaged, the following screen (Fig. 9) is displayed. In this case, press (Exit) to stop the update and then start over again from Step 1.

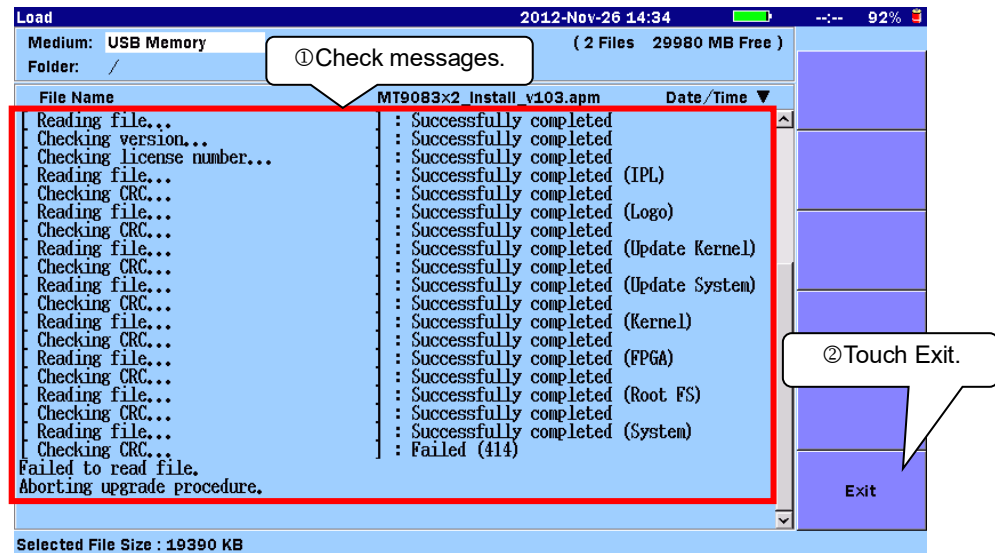

Fig. 9 Firmware Update Stop Screen

2. If the screen shown in Fig. 9 is not displayed, the MT9085 Series ACCESS Master does not restart automatically, cut the power and restart from Step 2 above. (Press the MT9085 Series ACCESS Master Power button for at least 10 seconds to forcibly shut down.)
 - (a) If the firmware cannot be updated after the restart, cut the power and contact our sales representative immediately.
 - (b) If the MT9085 Series ACCESS Master will not restart, contact our sales representative immediately.

Step 6: Checking firmware updated correctly

After the MT9085 Series ACCESS Master restarts in Step 5, run the Self Test in Step 3 and check the firmware versions.

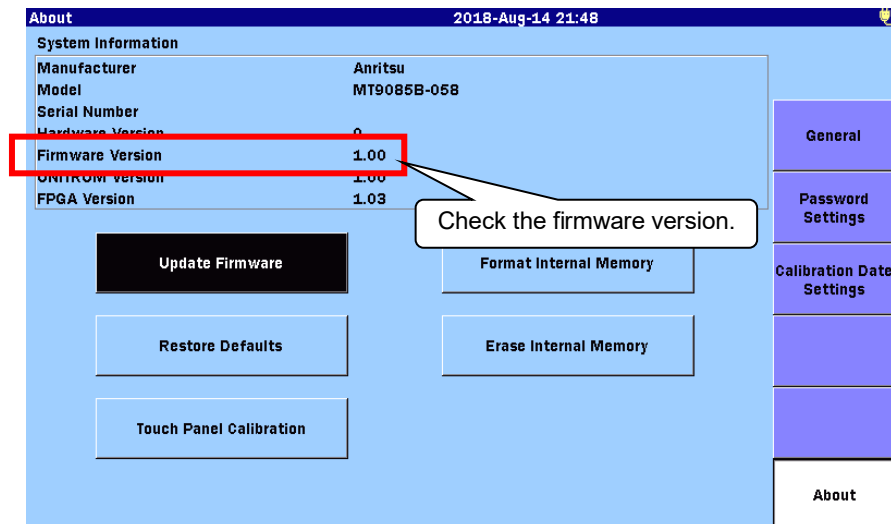

Fig. 10 About Screen

Firmware Update Notes

- Download the newest firmware from the following URL.
➤ <https://www.anritsu.com/test-measurement/products/mt9085series>
- Anritsu has confirmed compatibility with USB memory from the makers listed in the following table. If your USB memory is not recognized by the MT9085 Series ACCESS Master, please purchase one of the supported media types.

Manufacturer	Model/capacity
Biocryptodisk	ISPX/4GB
BUFFALO	RUF2-E1G-B / 1GB
	RUF2-J4GS-BK / 4GB
	RUF3-C16G-GR / 16GB
ELECOM	MF-SU204GBK / 4GB
I-O DATA	ToteBag / 1GB
	ToteBag / 4GB
	TB-OC4G/B / 4GB
Kingston	DataTraveler / 16GB
SiliconPower	LUXMINI / 2GB
	TOUCH 810 / 8GB
Sony	POCKET BIT / 512MB Turbo
	POCKET BIT / 8GB
Transcend	JetFlash / 256MB
TOSHIBA	TransMemory / 8GB

- NEVER remove the USB memory inserted into the MT9085 Series ACCESS Master while updating, otherwise the firmware update will fail, leaving the MT9085 Series ACCESS Master unable to restart.
- When updating the firmware, do not press any key on the MT9085 Series ACCESS Master, otherwise the firmware update may fail, leaving the MT9085 Series ACCESS Master unable to restart.
- When updating the firmware, do not turn off the power to the MT9085 Series ACCESS Master, otherwise the firmware update will fail, leaving the MT9085 Series ACCESS Master unable to restart.
- When updating the firmware, do not remove the AC adapter plug from the MT9085 Series ACCESS Master, otherwise the firmware update may fail, leaving the MT9085 Series ACCESS Master unable to restart.

- If the firmware update fails and the MT9085 Series ACCESS Master cannot restart, please contact our Anritsu sales representative.
- Note that firmware downgrade from 2.01 or later to 2.00 or earlier is not possible.