

Automating UE Verification Tests

Signalling Tester MD8475A

SmartStudio MX847570A

SmartStudio Manager MX847503A

- Automation Tool
- Basic Test Sequence

■ Importance of Repeat Testing

Software updates are a key part of UE development and repeat testing is vital to verify UE operation at every update. Efficient repeat testing is an important part of UE development.

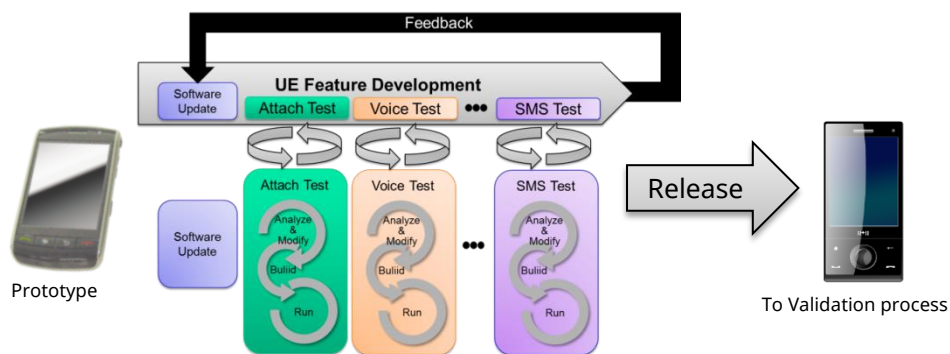

■ Automated UE Verification with Test Sequences

The MD8475A with intuitive SmartStudio MX847570A GUI software supports easy creation of test environments for various UE functions without test scenarios. In addition, developers can automate various manual operations using the SmartStudio Manager MX847503A option for controlling the GUI externally. Moreover, users do not need to operate UEs under test manually, because the MX847503A control interface supports efficient automatic testing. This solution improves UE performance and software regression tests, such as repeated Attach and Out-of-Service tests to verify UE current consumption and battery durability, voice and SMS sending/receiving tests, etc. The MX847503A also has versatile test sequences for evaluating basic UE functions automatically, greatly shortening development time.

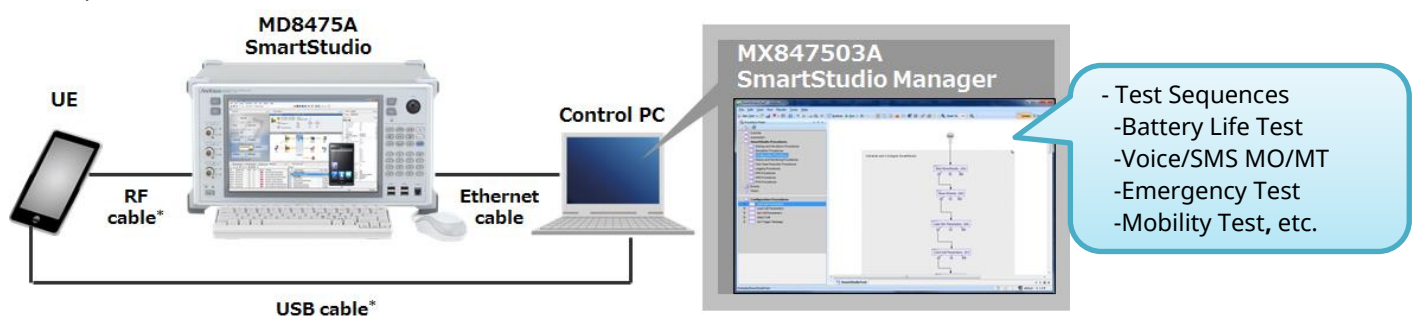

*Provided by users

SmartStudio Manager MX847503A Usability

Installing the MX847503A software offers an easy-to-use test environment with consecutive execution of multiple test cases and at-a-glance display of test results. Provided versatile test cases support basic UE operations, such as voice calls, SMS, handover, etc., eliminating problems in creating and editing new test cases. When new test cases are required, they are created easily by dragging, dropping, and changing parameters.

Sets number of test execution times, timeout, etc.

Test Sequence selection

Drag & Drop

Selects test execution file

Adds required flow using drag and drop

The Test case is LTE Attach. Cell Parameters: Band 19, Bandwidth 20Bhz Describes test contents by inputting comments to test sequence

Runs test sequence as sequential flow from top. Selecting each flow displays parameter change screen.

Test Run Report

Passed	
Start	2015-09-18 16:44:06, 15 seconds
Status	Passed; ran to completion
Watermark	Not Watermarked
Comments	n/a
Run name	SampleTestcase_2015-09-18_16.44.06
Criteria Evaluation	
Path_Criteria_Group_1	All Achieved
Criteria Detail	
Path_Criteria_Group_1 / Path_Criteria_1	Achieved
BasicTestPackage1.6.0_Rev1 / SampleTestcase	
Version	n/a
Last-modified	2015-09-18 16:29:03
Procedure Library	SmartStudio Procedures (1.13.0_1.13.0)
Defaults Procedure	None

Report generated: 2015-09-18 16:44:21 by MX847503A_1_6_0_A

Versatile Test Sequence Lineup

In addition to test sequences for evaluating basic UE functions, the SmartStudio Manager MX847503A sample test sequences*¹ provide test cases for measuring power consumption. The MX847503A software controls both SmartStudio and peripheral instruments simultaneously, cutting time to configure a UE evaluation environment.

*¹Test sequences may change without prior notice

Battery Durability Test Setup

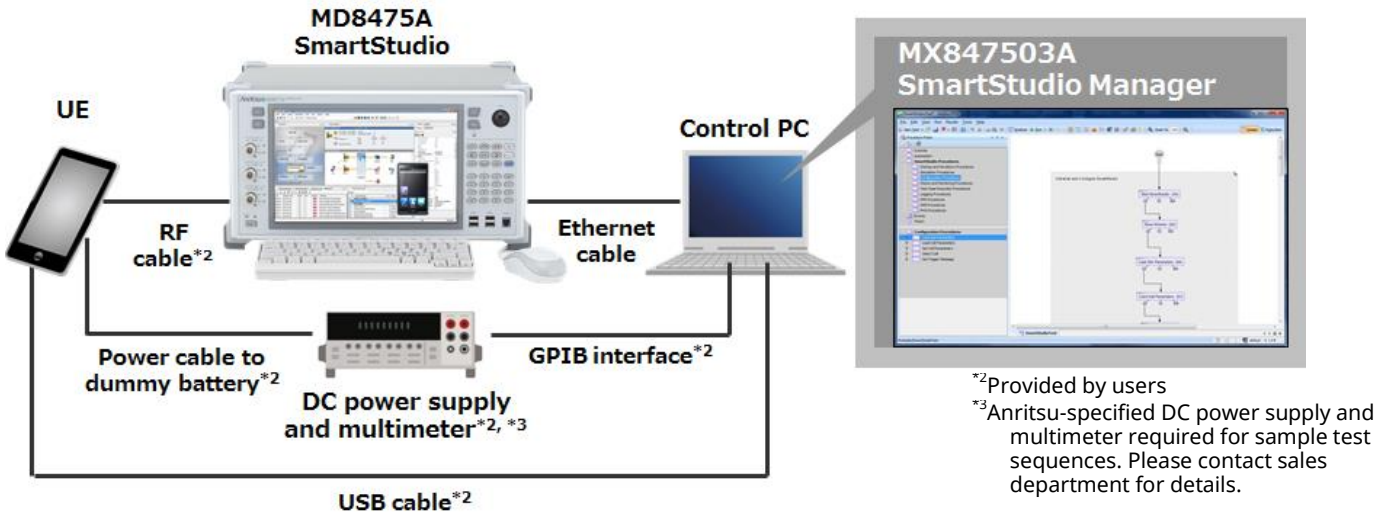

Sample Test Sequences (Extract)

Category	Procedure	Comment
Registration	Attach Out of Service	Testing UE and base station registration, etc.
Voice/Packet/SMS	Voice Packet SMS over SGs MOMR/ MTNR CSFB	Basic UE tests such as voice, data, CSFB, etc.
PWS	ETWS Primary + Secondary Notification CMAS Concurrent Notification CMAS	Emergency message tests
Cell Barred	Cell Barred Access Class Barred PSIST	Network restriction tests
CS Emergency	CS emergency CS emergency CSFB	Emergency call tests
Stress Test	Voice Handover Throughput testing Cell Selection/Reselection	Basic function tests and throughput tests
Mobility	Handover MOMR/MTNR SRVCC	Handover tests
WLAN Offload	Untrusted non-3GPP access Trusted non-3GPP access	WLAN Offload tests
IMS/RCS	MO/ MT SMS over IMS MOMR: Voice/Video Call Establishment/Release RCS Registration	IMS/RCS tests
TS 09	Stand-by test MOMR: Talk time Test MTNR: Talk time Test Packet Switch Transfer Test Browsing Test Streaming Content Test (Video/Audio) Video Telephony Test FTP Download Test	TS 09 power consumption tests

*⁴This list is an excerpt from available sample test sequences.

■ Option Software for Automated Test Environment

IP Tester Control Library MX847503A-901

The MX847503A-901 software option controls the IXIA IxChariot remotely to configure a more efficient and flexible automated IP Throughput test environment under various test conditions. Additionally, both the MX847503A-901 and IxChariot control console are accommodated using only one external PC.



IxChariot® is a registered trademark of Ixia.

Smartphone Control Platform MX847504A

The MX847504A software option records Android OS Smartphone operations and offers an environment for creating, editing, and running UE automated control scripts. UE pre-release regression and stable operation confirmation testing are easy using the intuitive editing environment with pre-installed scripts and GUI.

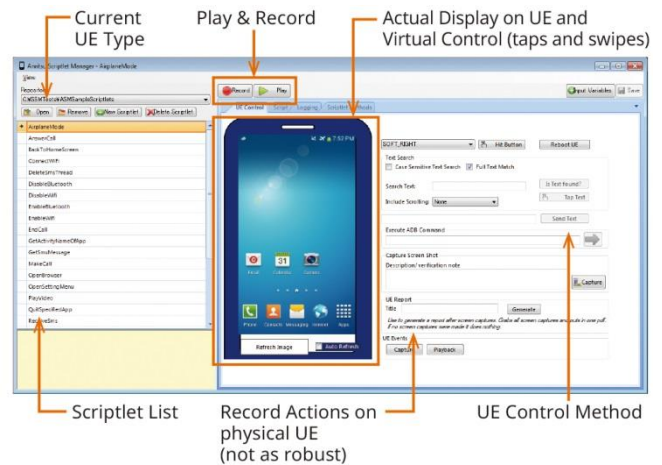

Android™ is a trademark of Google Inc.

■ Ordering Information

Model	Name	Function Outline	Note
MX847503A	SmartStudio Manager	Software for controlling SmartStudio from external PC, plus test sequences for evaluating UE	- Recommended PC specifications: Intel Core i5 @2.4 GHz or better Memory 4 GB or better 200-GB Hard drive or better 1 Spare USB port for dongle 1 Ethernet interface (1 Gbits/s) Windows7/8 Professional 64-bit (SP1) English Version Second Ethernet port or USB-to-Ethernet converter (When using MX847503A-901)
MX847503A-901	IP Tester Control Library	Software for controlling IxChariot made by IXIA from external PC	
MX847504A	Smartphone Control Platform	Software for controlling Android OS Smartphone from external PC	
Z1813A	USB Dongle (Automation)	USB license dongle for booting MX847503A	